

10

RT16	Low Voltage Fuse	-----	1
RT18	Fuse	-----	2
RT14	Fuse	-----	3
H.R.C Fuse	Cut Out Fuse	-----	3
NGT H.R.C	Fuse Links	-----	4

## RT16 Low Voltage Fuse



RT16-00C



RT16-00

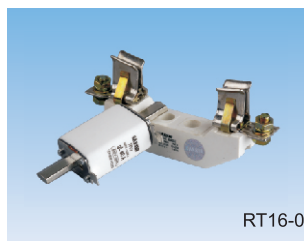

RT16-0



RT16-1

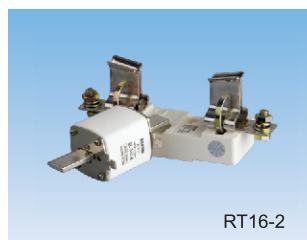

RT16-2

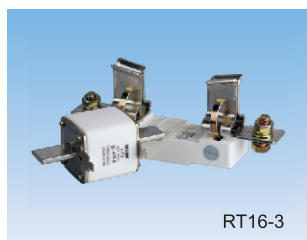

RT16-3



RT16-4



NT58 FUSE PULLER

### Application

Type RT16 low voltage H.R.C. fuse features light weight, compact size, low power consumption and high breaking capacity. This product has been widely used in overload and short circuit protection for electric installations.

This product conforms to IEC 60269.

### Specification

#### Carrier Fuse

Fuse model		Rated voltage (V)	Rated current (A)	Overall dimension						Weight (g)
SASSIN	Similar products at home and abroad			Drawing	A	B	C	D	H	
RT16-00C-F	NT00C/RO30C	500/660	4~160	Fig 1	78	49	15	21	52.5	132
RT16-00-F	NT00/NH00/RO313NE80	500/660	4~160	Fig 2	78	49	15	29	56	175
RT16-0-F	NT0/NH0/RT20-03NA	500/1140	4~160	Fig 2	125	68	15	29	56	252
RT16-1-F	NT1/NH1/RT20-13NA1	500/660	63~250	Fig 3	135	68	20	48	60	455
RT16-2-F	NT2/NH2/RT20-23NA1	500/660	80~400	Fig 3	172	110	19.5	44	58	570
RT16-3-F	NT3/NH3/RT20-3RO34	500/660	160~630	Fig 3	135	68	20	40	68	393

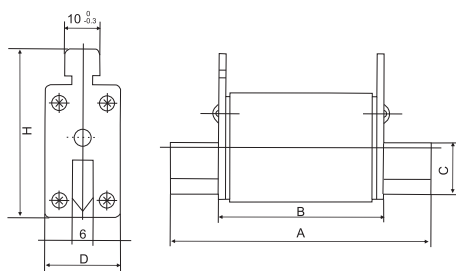

Fig 1

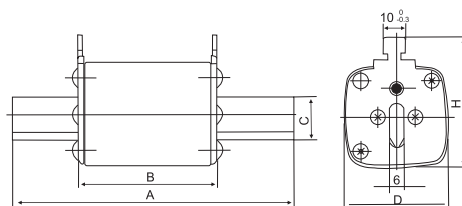

Fig 3

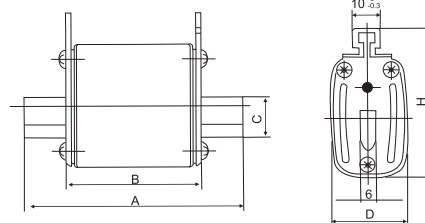

Fig 2

## RT16 Low Voltage Fuse

### Base

Products model	Matched with fuse body measurement	Rated insulated voltage	Convention heating current	Overall dimension(mm)									Weight
				Drawing	A1	A2	A3	B1	B2	H1	H2	Φ d	
RT16-00-B	RT16(NT00 NT00C)	660	160	Fig 1	25	100	120	-	-	25	60	-	193
RT16-0-B	RT16-0(NT0)	660	160	Fig 2	25	100	120	30	-	25	60	-	195
RT16-1-B	RT16-1(NT1)	660	250	Fig 3	25	175	200	30	58	38	84	10.5	550
RT16-2-B	RT16-2(NT2)	660	400	Fig 3	25	200	225	30	60	38	84	10.5	770
RT16-3-B	RT16-3(NT3)	660	630	Fig 3	25	210	250	30	60	40	105	10.5	965

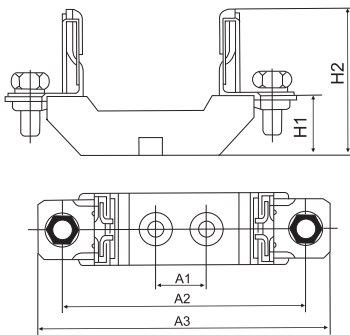

Fig 1

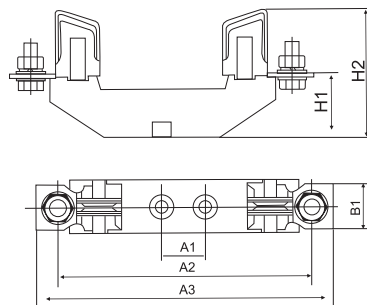

Fig 2

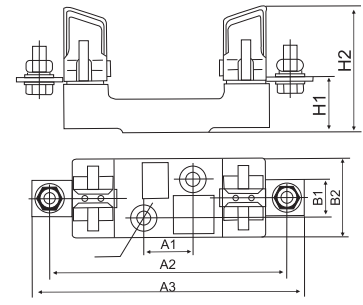

Fig 3

## RT18 Fuse



RT18-32X



RT18-32



RT18-63X



RT18-63

## RT14 Fuse

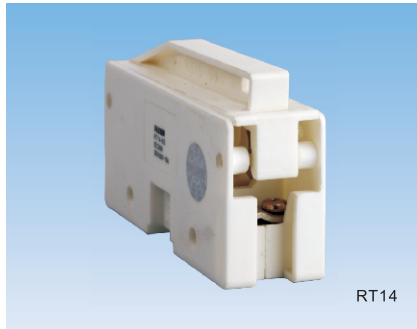

RT14

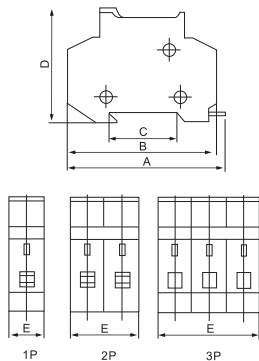

RT18 installation dimension

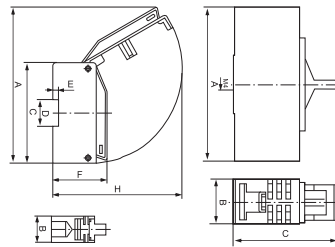

RT14 installation dimension

### ■ Specification

Type	Rated voltage (V)	Rated current(A)	Weight (kg)	Dimension(mm)				
				A	B	C	D	E
RT18-32 1P	380	32	0.075	82	78	35	63	18
RT18-32 2P		32	0.15	82	78	35	63	36
RT18-32 3P		32	0.22	82	78	35	63	54
RT18-63 1P	380	63	0.18	106	103	35	80	26
RT18-63 2P		63	0.36	106	103	35	80	52
RT18-63 3P		63	0.54	106	103	35	80	78

Type	Rated voltage (V)	Rated current (A)	Weight (kg)	Dimension(mm)							
				A	B	C	D	E	F	G	H
RT14-20	500	16	0.082	69	20	47	—	—	—	—	—
RT14-32		32	0.16	185	27.5	105	27	3.5	57	145	—
RT14-63		63	0.29	195	34	125	26	3.5	65	160	—

## H.R.C Fuse



30X58 22X58 14X51 10X38



RO22 RO21

### ■ Application

The fuses with fuse links with cylindrical contact caps are designed for protection of electrical distributing installations of rated voltage of 380V AC, with rated current up to 125A against overload and short circuit.

Fuse links with the striker are supplied for the purpose of protecting motors against motor single phasing operation when fitted in fuse isolators.

### ■ Specification

Dimension mm	Rated current (A)	L	Hmax	ΦC
		mm		
8.5×31.5	2,4,6,10,16	31.5±0.6	8.5	8.5±0.1
10×38	2,4,6,10,16,20,25,32	38±0.6	10.5	10.3±0.1
14×51	2,4,6,10,16,20,25,32,40,50,63	51± <sup>0.6</sup> <sub>-0.1</sub>	13.8	14.3±0.1
22×58	10,16,20,25,32,40,50,63,80,100	58± <sup>0.1</sup> <sub>-2.0</sub>	16.2	22.2±0.1
30×58	63,80,100,125,	58± <sup>0.1</sup> <sub>-2.0</sub>	16.2	30±0.1

## H.R.C Fuse

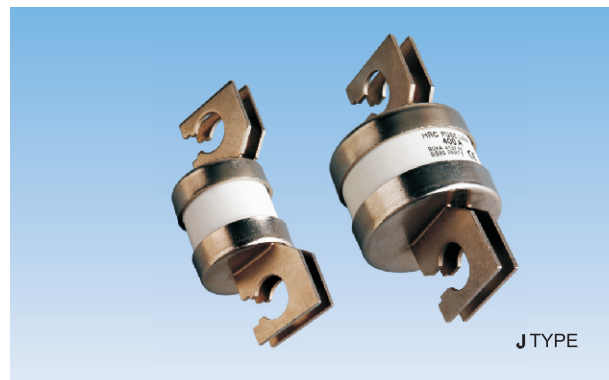

### Application

NGT low voltages fuse features high breaking capacity, low power consumption and stable and reliable performance. This product conforms to IEC60269.

### Specification

Fuse model		Rated voltage(V)	Rated current (A)	Overall dimension(mm)										Weight (g)
This company	Similar products at home and abroad			Drawing	A	B	C	D	E	F	H	Φd		
NGT00 HLS00	RS711B	380/800	32~200	Fig 1	50	77	100	29	27	2	51	11	198.5	
NGT1	RS6-1	380/660/1000	100~250	Fig 2	68	110	140	48	16	-	6	10.5	458	
NGT2	RS6-2	380/660/1000	200~400	Fig 2	68	110	140	58	32	-	6	10.5	654	
NGT3	RS6-3	380/660/1000	355~630	Fig 2	68	110	140	67	38	-	6	10.5	920	

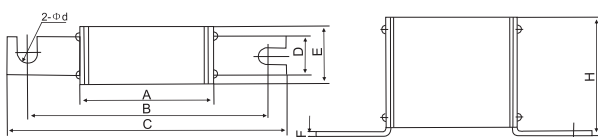

Fig 1

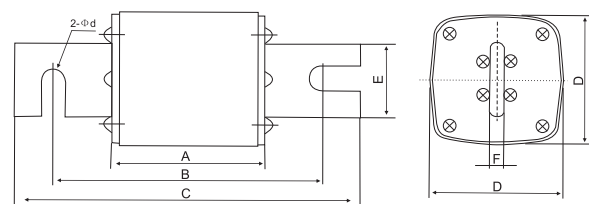

Fig 2